

ATR Thermal Circuit Protector for Equipment



Specifications:

Current Ratings: 0.5A - 16A, Standard Ratings Available
 Rated Voltage: 240 Vac, 50/60HZ, 32Vdc, 24Vdc (VDE)
 Resettable Overload Capacity: $8 \times I_n$ for $< 6A$,
 $6 \times I_n$ or $60A$ max. $\geq 6A$

Operating Temperature: 60°C Max. Ambient
 Max. Interrupting Capacity: 1000A
 Insulation Resistance: >100 megohms
 Dielectric Strength: 1.5 KV for 1 min. (per IEC 60934)
 Operational Life: 1000 Cycles @ $2 \times I_n$

Designed to meet: Shock: per MIL-STD-202, method 213,
 test condition I
 Vibration: per MIL-STD-202, method 204
 test condition A

Warranty: 24 months from date of
 manufacture, as marked on unit

Airpax Expands Offering

Airpax, a global leader in the supply of power protection products, has expanded its offering to include the new ATR thermal circuit protector for equipment. The ATR is a single pole, thermally operated overload protector with a snap-acting trip mechanism that provides reliable, trip-free operation on current overloads.

The ATR comes with an unequaled 24-month warranty.

Please contact Airpax for assistance in applying the ATR thermal circuit protector to meet your power protection needs.

AIRPAX
www.airpax.net

Airpax Corporation
 807 Woods Road
 Cambridge, Maryland 21613 USA
 Tel: 410.228.1500 Fax: 410.228.3456

AIRPAX

Application: Typical applications include power strips, single-phase motors, transformers, solenoids, UPS, etc.

Operation: The trip mechanism of the circuit protector is designed to open the contacts in the event of a current flow in excess of the rated current and in accordance with the time/current characteristics of the device. A bimetal strip deflects and releases the latch mechanism when heated by an overload. The strip has the advantage of being immune to high inrush currents and line transients. The contacts open and close with a positive snap action, and the tripped state is clearly indicated by the protruding reset button.

Shunt Terminal (Option N): Available on units of up to 6 amps equipped with a heater winding, an optional additional terminal can be provided as a parallel circuit to the main current-sensing circuit. The shunt circuit between terminals 1 and 3 may be used for any signal that may be required in addition to the main circuit. However, since the circuit makes use of the bimetal strip as a current-carrying path, the trip time of the circuit protector may be slightly influenced.

Time/Current Characteristics: The standard characteristic is valid for an ambient temperature of 23°C. However, if the device is to be used in an ambient temperature other than 23°C, an allowance must be made when selecting the current rating. See the following guidelines:

Ambient Temperature Correction Factor

Ambient Temp. (°C)	-20	-5	0	+10	+20	+30	+40	+50	+60
Multiplication Factor	0.8	0.88	0.9	0.96	1	1.05	1.12	1.2	1.3

Example:
 Normal Continuous Current:
 1.8 A
 Ambient Temp.:
 40°C
 Multiplication Factor:
 1.12
 Recommended Rating:
 $1.8 \times 1.12 = 2.016$
 Select the Nearest Rating:
 2 A

Approvals:



Up to 16A



Up to 12A

**RoHS
Compliant**

Operating Characteristics:

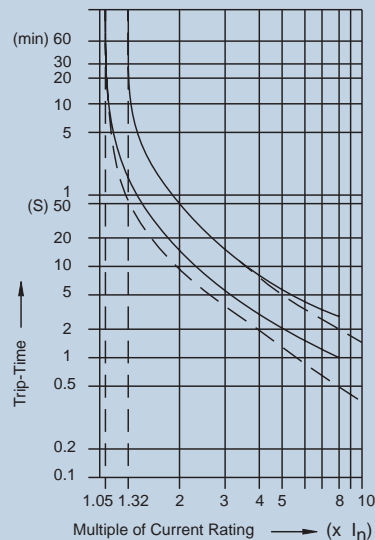

Rated Current
 ——— $< 6A$
 ——— $\geq 6A$
 Ambient Temperature 23°C

Mounting Options: $\frac{\text{inch}}{\text{mm}}$

C - Central Nut Mounting

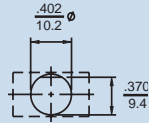
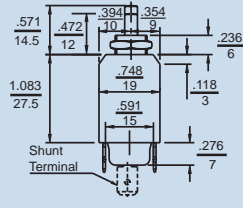
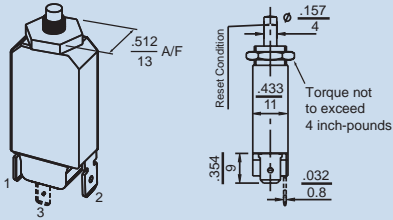

Protective Cover:
Dust/Splash (IP54)
P/N 053-000-0001

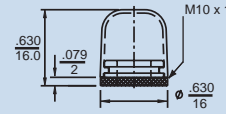

Knurled Nut:
P/N 053-000-0002

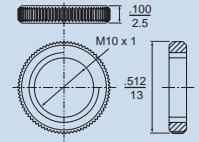
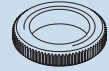

W - Wing Clip Mounting

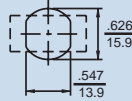
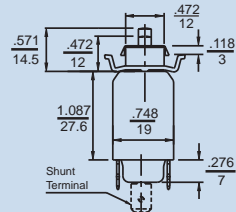
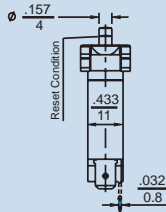
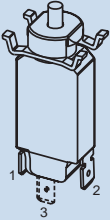

"W" Type
Double "D"
Panel Cutout

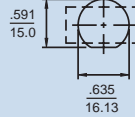

"D" Type
Single "D"
Panel Cutout

S - Snap-in Mounting

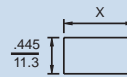
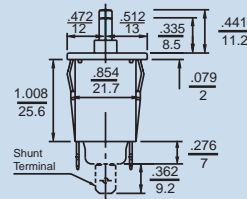
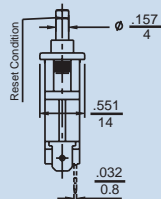
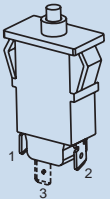

Panel Thickness	'X'
.032	.862
.039	.866
.059	.870
.079	.878
.118	.890

B - Integral Mounting

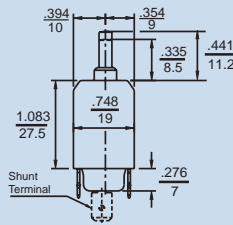
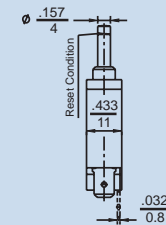
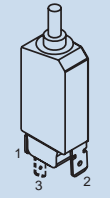

P - PCB Mounting

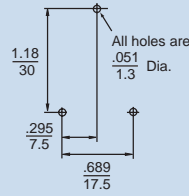
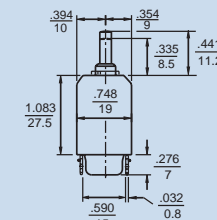
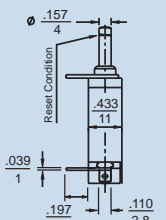
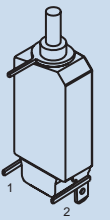

AIRPAX
www.airpax.net

Airpax Corporation
807 Woods Road
Cambridge, Maryland
21613 USA
Tel: 410.228.1500
Fax: 410.228.3456

1 First Decision
Type
ATR11 Single pole, series, thermal circuit protector

ATR11 - C - X - 63 - R - 7.0A

6 Sixth Decision
Standard Current Ratings*
0.5, 0.9, 1.0, 1.2, 1.5, 1.8, 2.0, 2.2, 2.5, 2.7, 3.0, 3.3, 4.0, 5.0, 6.0, 6.5, 7.0, 8.0, 9.0, 10.0, 12.0, 15.0, 16.0
*For other ratings, please consult the factory.

2 Second Decision
Mounting
C Central hex nut
W Wing clips
D Wing clips
S Snap-in
B Integral
P PCB

3 Third Decision
Terminal Configuration
X Terminal 1 & 2
Y Terminal 1 & 3
N Shunt Terminal

4 Fourth Decision
Terminal
63 .250 Q.C. terminal
48 .187 Q.C. terminal
28 .110 Q.C. terminal
PCB .040 solder terminal

5 Fifth Decision
Reset Button Color
R Red
B Black
W White
RB Red w/trip band
BB Black w/trip band
WB White w/trip band

Note:
Terminals 1 & 2 are standard for current ratings \leq 6A
Terminals 1 & 3 are standard for current ratings $>$ 6A
Terminals 1 & 2 are optional for current ratings \leq 8A