

ORIGINAL

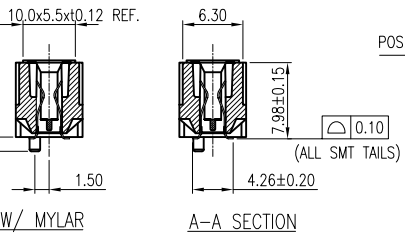

REVISIONS				
SYM	ECN No.	DESCRIPTION	DATE	BY
A	NE-17089	RELEASE TO PRODUCTION	2017.04.26	Sondra Sang
B	NE-17318	ADDED PACKING OPTIONS IN PNS	2017.12.18	Sondra Sang

This document is the property of Amphenol Corporation and is delivered on the express condition that is not to be disclosed, reproduced or used, in whole or in part, for manufacture or sale by anyone other than Amphenol Corporation without its prior consent, and that no right is granted to disclose or to use any information in this document.
The marking on this product doesn't contain environmental hazardous materials per Material Specification SS-00259 for Sony GP compliant or per directive 2011/65/EU for RoHS compliant or per IEC 61249-2-21 for Halogen-Free compliant.

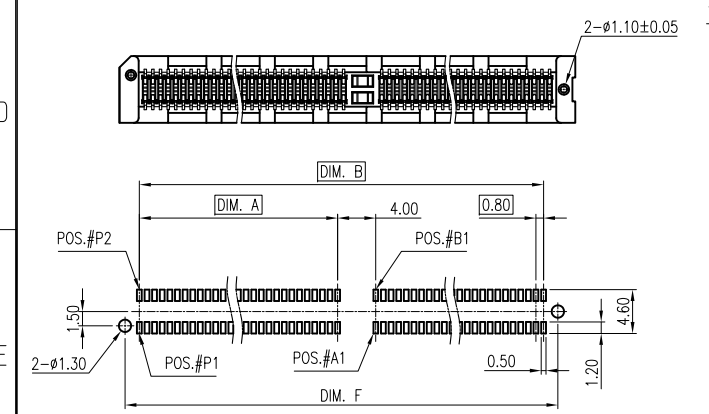
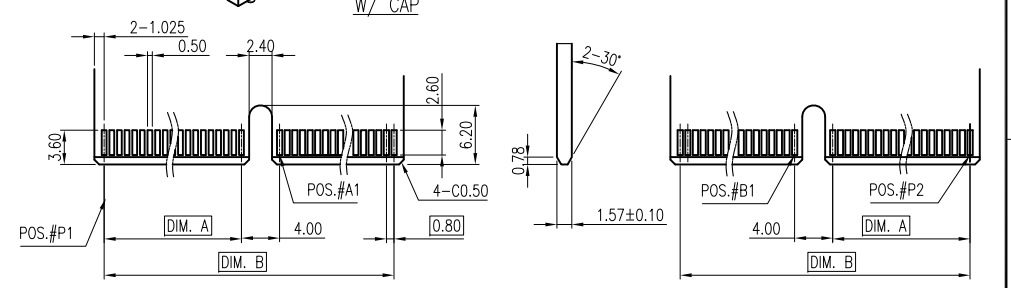
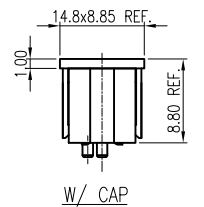
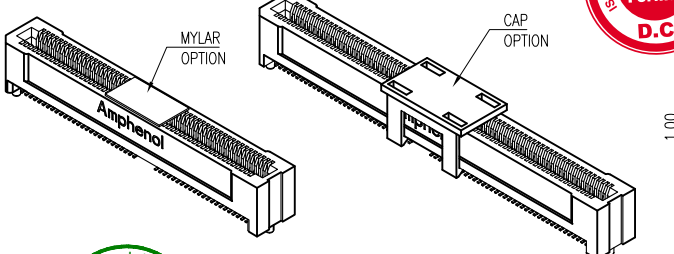
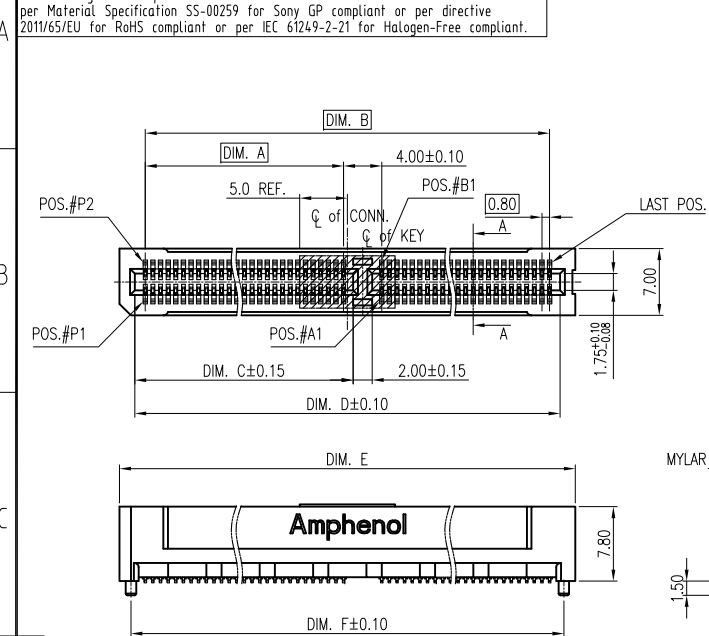

DATE CODE
X X X X
DATE (1~7: SUNDAY~SATURDAY)
WEEK (25: THE 25TH WEEK)
YEAR (5: 2015)

RECOMMENDED DAUGHTER CARD
(GENERAL TOLERANCES: ±0.05)

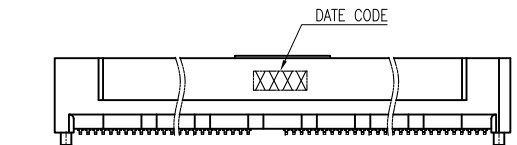

PART NUMBER: G639F XXX X 5 110 X HR
NO OF POS. PACKAGE OPTION
CONTACT FINISH
0: GOLD FLASH
1: 15µ" GOLD
2: 30µ" GOLD
1: TRAY PACKING
2: W/ MYLAR, T&R PACKING (18~100 POS.)
3: W/ CAP, T&R PACKING (120~200 POS.)
4: W/ CAP, HARD TRAY PACKING (200 POS. ONLY)
5: W/O CAP, HARD TRAY PACKING (200 POS. ONLY)
6: W/O MYLAR & W/O CAP, T&R PACKING

POS.	DIM. A	DIM. B	DIM. C	DIM. D	DIM. E	DIM. F
200	24.80	82.40	26.90	84.60	87.80	85.40
180	24.80	74.40	26.90	76.60	79.80	77.40
160	24.80	66.40	26.90	68.60	71.80	69.40
140	24.80	58.40	26.90	60.60	63.80	61.40
120	24.80	50.40	26.90	52.60	55.80	53.40
100	20.80	42.40	22.90	44.60	47.80	45.40
98	20.80	41.60	22.90	43.80	47.00	44.60
80	16.80	34.40	18.90	36.60	39.80	37.40
74	16.00	32.00	18.10	34.20	37.40	35.00
64	13.60	28.00	15.70	30.20	33.40	34.00
50	4.00	22.40	6.10	24.60	27.80	25.40
26	4.00	12.80	6.10	15.00	18.20	15.80
18	2.40	9.60	4.50	11.80	15.00	12.60

- NOTES:
(GENERAL TOLERANCES: ±0.05)
- HOUSING: HIGH TEMPERATURE THERMOPLASTIC, UL 94V-0, COLOR- BLACK
 - CONTACT: COPPER ALLOY, SELECTIVE GOLD PLATED ON CONTACT AREA, 100µ" MIN. MATTE TIN PLATED ON SOLDERING TAIL, 50µ" MIN. NICKEL UNDER-PLATED OVERALL
 - PACKING DRAWING REFER TO PKS-G639FP001HR & PKS-G639FP003HR & PKS-G639F200P004HR & PKS-G639F200P005HR
 - THIS PRODUCT DOESN'T CONTAIN ENVIRONMENTAL HAZARDOUS MATERIALS PER R DIRECTIVE 2011/65/EC FOR RoHS AND PER IEC 61249-2-21 FOR HALOGEN FREE COMPLIANT.

TOLERANCE	DRAWN	APPROVALS	DATE
X		Sondra Sang	12/18/2017
X.X	±0.30		
X.XX	±0.20		
X.XXX	±0.10	Chenny Yeh	12/18/2017
ANGULAR	±2°	Hank Hsu	12/18/2017
UNLESS OTHERWISE SPECIFIED		CUST DWG	PROJECT CODE T561

TITLE: CARDEDGE SUPER ST. CONN.
HIGH SPEED, VERTICAL SMT

Amphenol®
Amphenol Corporation
Amphenol Taiwan Corporation

PART No. G639F XXX X 511 0X HR
DWG No. G639FXXX5110XHR
REV. B

UNIT: mm, SCALE: NA, SHEET: 1 OF 2

This document is the property of Amphenol Corporation and is delivered on the express condition that is not to be disclosed, reproduced or used, in whole or in part, for manufacture or sale by anyone other than Amphenol Corporation without its prior consent, and that no right is granted to disclose or to use any information in this document.
 The marking on this product doesn't contain environmental hazardous materials per Material Specification SS-00259 for Sony GP compliant or per directive 2011/65/EU for RoHS compliant or per IEC 61249-2-21 for Halogen-Free compliant.



ORIGINAL



REVISIONS				
SYM	ECN No.	DESCRIPTION	DATE	BY
A	NE-17089	RELEASE TO PRODUCTION	2017.04.26	Sondra Sang
B	NE-17318	ADDED PACKING OPTIONS IN PNS	2017.12.18	Sondra Sang

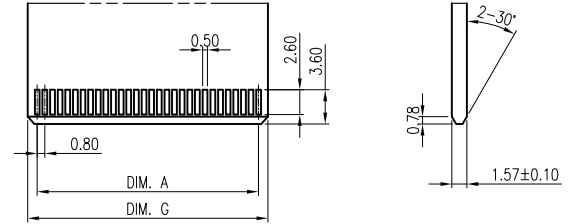
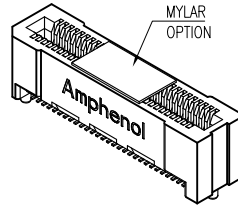
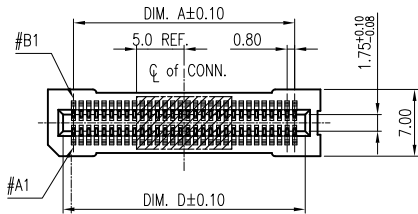

RECOMMENDED DAUGHTER CARD
(GENERAL TOLERANCES: ±0.05)

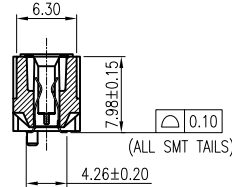
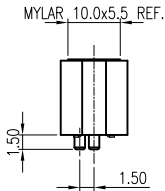
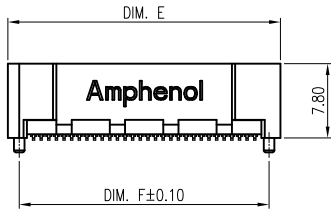

A-A SECTION

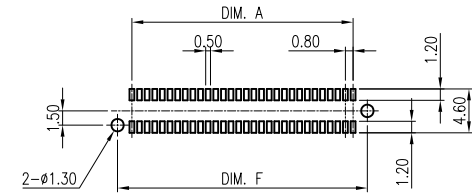
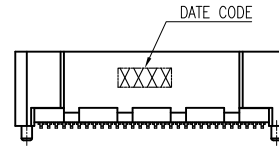

RECOMMENDED PCB LAYOUT - TOP VIEW
(GENERAL TOLERANCES: ±0.05)



PART NUMBER:
G639F XXX X 5 110 X HR

NO OF POS.

PACKAGE OPTION

- 1: TRAY PACKING
- 2: W/ MYLAR, T&R PACKING
- 6: W/O MYLAR, T&R PACKING

CONTACT FINISH

- 0: GOLD FLASH
- 1: 15µ" GOLD
- 2: 30µ" GOLD

DATE CODE
X X X X
DATE (1~7: SUNDAY~SATURDAY)
WEEK (25: THE 25TH WEEK)
YEAR (5: 2015)

POS.	DIM. A	DIM. D	DIM. E	DIM. F	DIM. G
68	26.40	28.60	31.80	29.40	28.40
60	23.20	25.40	28.60	26.20	25.20
40	15.20	17.40	20.60	18.20	17.20
34	12.80	15.00	18.20	15.80	14.80
20	7.20	9.40	12.60	10.20	9.20

NOTES:

1. HOUSING: HIGH TEMPERATURE THERMOPLASTIC, UL 94V-0, COLOR- BLACK
2. CONTACT: COPPER ALLOY, SELECTIVE GOLD PLATED ON CONTACT AREA, 100µ" MIN. MATTE TIN OVER 50µ" MIN. NICKEL UNDER-PLATED OVERALL 50µ" MIN. NICKEL UNDER-PLATED OVERALL
3. PACKING DRAWING REFER TO PKS-G639FP001HR & PKS-G639FP003HR
4. THIS PRODUCT DOESN'T CONTAIN ENVIRONMENTAL HAZARDOUS MATERIALS PER R DIRECTIVE 2011/65/EC FOR RoHS AND PER IEC 61249-2-21 FOR HALOGEN FREE COMPLIANT.

TOLERANCE	DRAWN	APPROVALS	DATE	TITLE	UNIT	SIZE	SCALE	SHEET	PART No.	DWG No.	REV.
X. X.X ±0.30 X.XX ±0.20 X.XXX ±0.10	DESIGNED	Sondra Sang	12/18/2017	CARDEDGE SUPER ST. CONN. HIGH SPEED, VERTICAL SMT	m	A3	NA	1 OF 2	G639F XXX X 511 0X HR	G639FXXX5110XHR	B
	CHECKED	Chenny Yeh	12/18/2017								
ANGULAR ±2°	APPROVED	Hank Hsu	12/18/2017								
UNLESS OTHERWISE SPECIFIED	DWG TYPE	CUST DWG	PROJECT CODE T561								

Amphenol®

Amphenol Corporation
Amphenol Taiwan Corporation

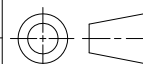

UNIT: m

SIZE: A3

PART No. G639F XXX X 511 0X HR

SCALE: NA

SHEET: 1 OF 2

DWG No. G639FXXX5110XHR

REV. B