

## Shielded Miniature Circular DIN Receptacles, Thru-Hole (Continued)

### Right-Angle Board-Mount Receptacles

#### Material and Finish

**Housing**—Thermoplastic, 94V-0 rated, black

**Contacts**—Copper alloy, duplex plated as follows:

**A**—Gold flash in mating area, .000120 [0.00305] min. tin-lead on solder tail, all over .000050 [0.00127] min. nickel underplating

**B**— .000030 [0.00076] gold min. in mating area, .000120 [0.00305] min. tin-lead on solder tail, all over .000050 [0.00127] min. nickel underplating

**Shield**—Copper alloy, plated .000059-.000158 [1.50-4.00µm] thick bright tin

#### Notes:

1. Recommended pc board thickness is .062 [1.57].
2. This connector ensures grounding to the front panel when the gap between the pc board edge and the panel is no greater than .060 [1.52].

#### Technical Documents

##### Product Specification

108-1225

##### Application Specification

114-40031

△See application specification 114-40031 for layout dimensions.

Part No. 749231-1

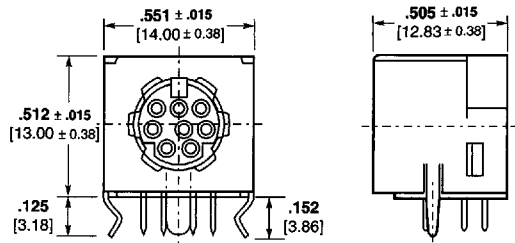
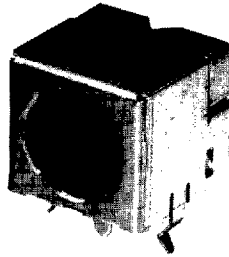

With Hold-Down

Part No. 749265-1

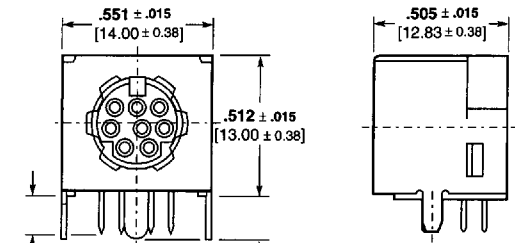
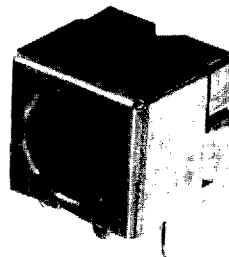

Without Hold-Down

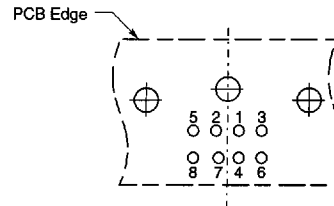

8-Pin PCB Layout Bottom View △

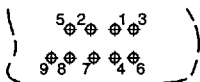
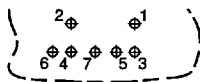

Special 7- and 9-Position PCB Layout Bottom View

No. of Positions	Duplex Plating Code	Part Numbers		
		With Hold-Down	Without Hold-Down	With Front Panel Grounding Fingers
3	A	—	749283-1	—
4	A	749230-1	749263-1	—
	B	749181-1	749264-1	750069-1 <sup>1</sup>
5	A	—	—	—
	B	749274-1	—	—
6	A	749231-1	749265-1	—
	B	749180-1	749266-1	750071-1 <sup>1</sup>
7	A	—	—	—
	B	—	749270-1	—
7*	A	—	—	—
Special	B	786766-3 <sup>1</sup>	—	—
8	A	749232-1	749268-1	—
	B	749179-1	749267-1	750073-1 <sup>1</sup>
9**	A	—	—	—
Special	B	786767-2 <sup>1</sup>	—	—

<sup>1</sup>Not certified by CSA

<sup>\*</sup>Also available in low temperature version; contact AMP Incorporated.

<sup>1</sup>Housing is grey thermoplastic, UL 94V-0 rated.

For drawings, technical data or samples, contact your AMP sales engineer or call the AMP Product Information Center 1-800-522-6752. Dimensions are in inches and millimeters unless otherwise specified. Values in brackets are metric equivalents. Specifications subject to change. Consult AMP for latest specifications.

## Shielded Miniature Circular DIN Receptacles, Thru-Hole

## Product Facts

- Compact size, same envelope dimension for all sizes — 3 through 9
- Available in 6 and 9-positions stacked configurations
- Stacked visual keying available
- Right-angle and vertical receptacles incorporate one-piece shield for excellent shielding effectiveness
- Polarized and keyed to prevent mismatching
- Housings made of 94V-0 rated thermoplastic, IR reflow compatible
- Right-angle receptacles compatible with robotic pick-and-place assembly
- Receptacles with fully formed socket contacts with proven retention system
- Receptacles accept plug connectors with or without latches

## Commercial Approvals

- Recognized under the Component Program of the Underwriters Laboratories Inc., File No. E28476 
- Certified by Canadian Standards Association File No. LR 7189 
- Produced under a Quality Management System certified to ISO 9001 

A copy of the certificate is available upon request.

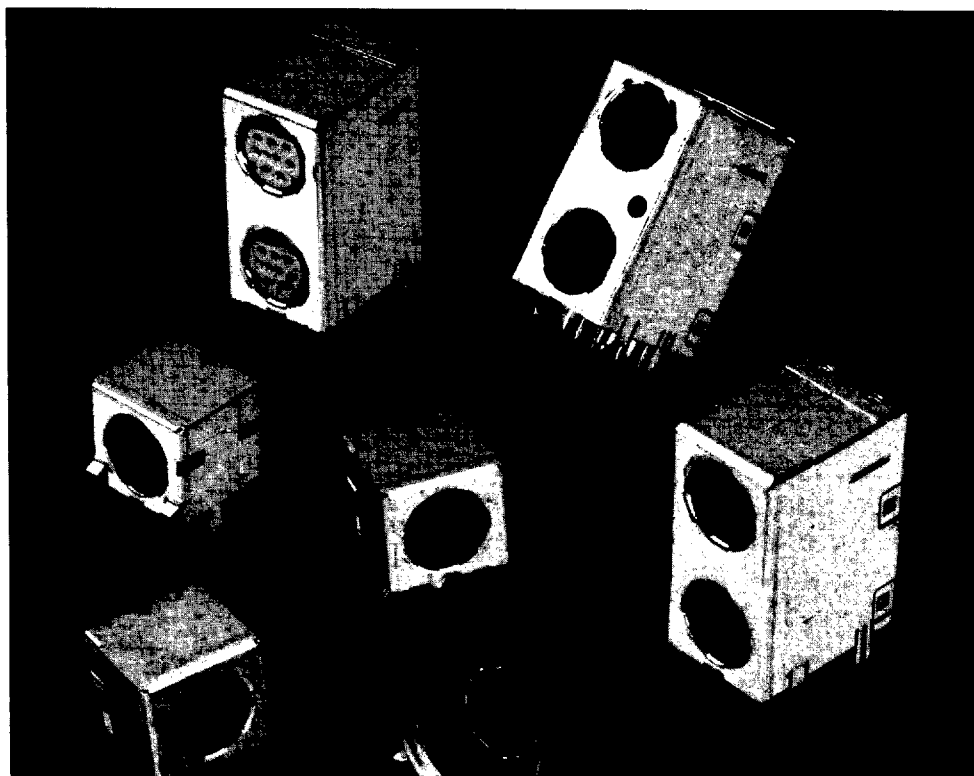

Shielded Miniature Circular DIN printed circuit board receptacles are ideal I/O connectors where board real estate is at a premium. All connectors are available in three through eight positions plus right-angle connectors are available in a nine position configuration. Stacked connectors are available in six and nine position configurations.

**Miniature Circular DIN, pcb thru-hole receptacles** are available in a choice of right-angle or vertical mount designs.

Right-angle receptacles are designed for automated assembly. They incorporate registration notch controlled datum surfaces and contact locations needed for robotic pick-up and placement. The housings, made of 94V-0 rated material, are designed to withstand the rigors of

IR reflow soldering. The right-angle design incorporates a one-piece copper alloy shield and features optional front panel grounding fingers which ensure direct grounding.

**Super VHS Shields are available — contact AMP Incorporated.**

Thru-hole contacts are tin-lead plated for easy soldering, while the receptacle's stand-off design prevents shield damage to the pc board traces, and enhances cleaning after soldering.

Vertical mount receptacles are offered in unshielded and two shielded configurations — with or without front panel screw-down.

## Performance Specifications

**Voltage Rating** — 30 VAC rms, or 30 VDC

**Current Rating** — 1 ampere, max.

**Dielectric Withstanding Voltage** — 500 VAC rms

**Termination Resistance** — 30 milliohms, max.

**Mating Force** — 9 lbs [40 N], max.

**Unmating Force** — 2 lbs [8.9 N], min.

**Durability** — 100 mating cycles for gold flash plating  
250 mating cycles for .000015 [0.00038] gold plating  
500 mating cycles for .000030 [0.00076] gold plating

**Application Temperature** — Max. 255°C for 4 min.

**Operating Temperature Range** — -55°C to +105°C

## Shielded Miniature Circular DIN Receptacles, Thru-Hole (Continued)

### Right-Angle Board-Mount Receptacles

(Continued)

Part No. 750071-1

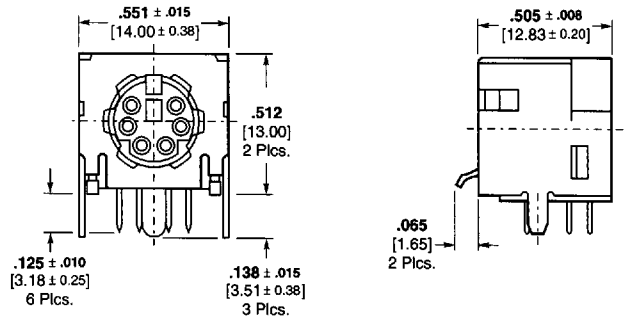
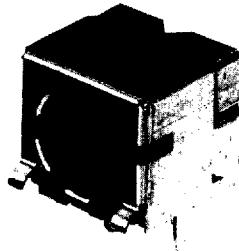

Without Hold-Down With Front Panel Grounding Finger

Part No. 786766-3

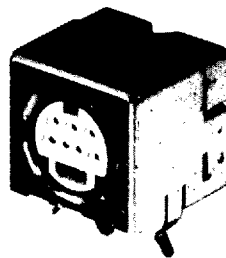

Part No. 786767-2\*

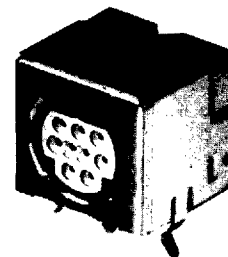

### PCB Receptacles Mating Faces, Right-Angle and Vertical

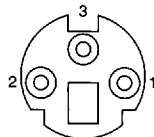

3-Position

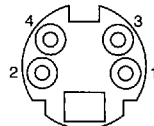

4-Position

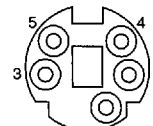

5-Position

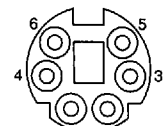

6-Position

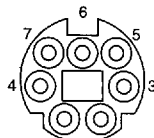

7-Position

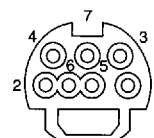

7-Position Special

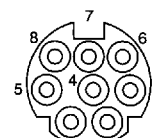

8-Position

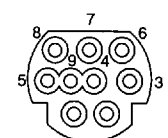

9-Position Special

\*Also available in low temperature version; contact AMP Incorporated.