

Series 801 Mighty Mouse Double-Start ACME Thread Plug 801-007 and 801-008 Ordering Information



Series 801



Series 801 Mighty Mouse Connector features a double-start modified stub ACME mating thread for improved protection against cross-mating and thread damage. Connector shells are machined aluminum or stainless steel. Supplied with crimp contacts, packaged separately. Terminate contacts with standard M22520 tools. Metal clips inside the connector body lock contact into place. Contacts are removable. Fluorosilicone seals and rear grommet protect connector from water ingress. Terminate cable shield directly to connector body with Band-Master™ ATS strap, or choose rear accessory thread to attach optional cable clamp or backshell. Available in shell sizes 5 through 21 in 67 contact arrangements.

How To Order			
Sample Part Number	801-007	-16	M 9-4 P A
Series (See Table I)	801-007 = With Banding Platform 801-008 = With Rear Accessory Thread		
Shell Style	-16 = Plug with Anti-Decoupling Spring -26 = Self-Locking Plug with Ratchet Mechanism		
Shell Material and Finish	C = Aluminum / Black Anodize (Non-Conductive) RoHS Compliant M = Aluminum / Electroless Nickel RoHS Compliant NF = Aluminum / Cadmium with Olive Drab Chromate ZN = Aluminum / Zinc-Nickel with Olive Drab Chromate ZNU = Aluminum / Zinc-Nickel with Black Chromate MT = Aluminum / Nickel-PTFE RoHS Compliant Z1 = Stainless Steel / Passivated RoHS Compliant		
Shell Size - Insert Arrangement	See Insert Arrangements page D-2		
Contact Type	Connector supplied with crimp contacts P = Pin S = Socket Connectors with contacts are supplied with signal and/or power crimp contacts. These contacts are not installed. Coaxial contacts and non-standard signal contacts are ordered separately.	Connector supplied without contacts A = Pin Connector B = Socket Connector	Connector supplied with 30 AWG crimp contacts G = #23 Pin H = #23 Socket
Shell Key Positions (See Table II)	A = Normal B = Pos. B C = Pos. C D = Pos. D E = Pos. E F = Pos. F G = Pos. G H = Pos. H J = Pos. J		

D

Table I: Series	
801-007 Banding Platform	801-008 Rear Accessory Thread

Table II: Plug Key Positions		
	A°	B°
A	150°	210°
B	75°	210°
C	95°	230°
D	140°	275°
E	75°	275°
F	95°	210°
G	75°	230°
H	95°	275°
J	140°	230°

Dimensions in Inches (millimeters) are subject to change without notice.

Series 801 Mighty Mouse Double-Start ACME Thread Plug 801-007 and 801-008 Dimensions

Plug connector

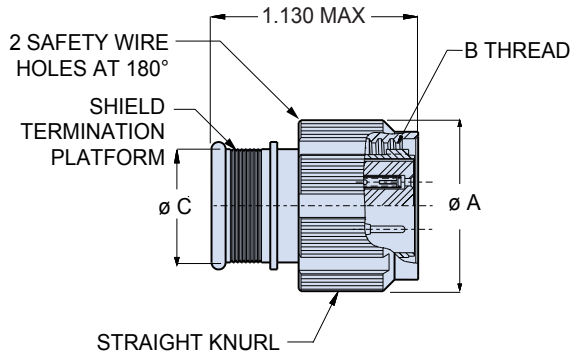

Integral Band Platform
801-007

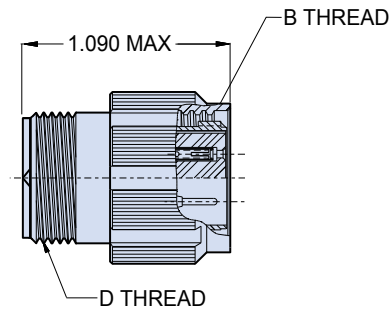

Accessory Thread
801-008

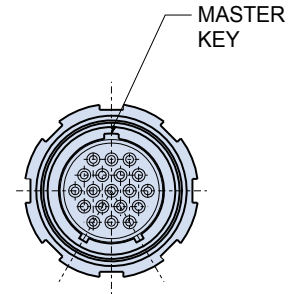

FACE VIEW OF PLUG AS
VIEWED FROM ENGAGING END.
SOCKET SIZE 9 SHOWN

D

Dimensions

Shell Size	Ø A Style 16		Ø A Style 26		B Thread	Ø C		D Thread
	In.	mm.	In.	mm.		In.	mm.	
5	0.54	13.72	0.65	16.51	.3125-.05P-.1L-DS-2B	.245	6.22	.2500-32 UNEF-2A
6	0.60	15.24	0.69	17.53	.3750-.05P-.1L-DS-2B	.290	7.37	.3125-32 UNEF-2A
7	0.69	17.53	0.79	20.07	.4375-.05P-.1L-DS-2B	.390	9.91	.4375-28 UNEF-2A
8	0.75	19.05	0.83	21.08	.5000-.05P-.1L-DS-2B	.445	11.30	.5000-28 UNEF-2A
9	0.81	20.57	0.92	23.37	.5625-.05P-.1L-DS-2B	.500	12.70	.5625-24 UNEF-2A
10	0.88	22.35	0.98	24.89	.6250-.05P-.1L-DS-2B	.560	14.22	.6250-24 UNEF-2A
11	0.92	23.37	1.02	25.91	.6875-.05P-.1L-DS-2B	.605	15.37	.6875-24 UNEF-2A
13	1.05	26.67	1.10	27.94	.8125-.1P-.2L-DS-2B	.650	16.51	.6875-24 UNEF-2A
16	1.24	31.50	1.34	34.04	1.0000-.1P-.2L-DS-2B	.805	20.45	.9375-20 UNEF-2A
17	1.30	33.02	1.45	36.83	1.0625-.1P-.2L-DS-2B	.850	21.59	.9375-20 UNEF-2A
19	1.40	35.56	1.50	38.10	1.1875-.1P-.2L-DS-2B	1.003	25.48	1.0625-18 UNEF-2A
21	1.55	39.37	1.65	41.91	1.3125-.1P-.2L-DS-2B	1.110	28.19	1.1875-18 UNEF-2A

Dimensions in Inches (millimeters) are subject to change without notice.