

# Datamate J-Tek Connectors

## Female Vertical Throughboard

- ❖ Fully shrouded contacts.
- ❖ Polarized housings.
- ❖ Mates with all Datamate J-Tek male connectors with compatible jackscrews.

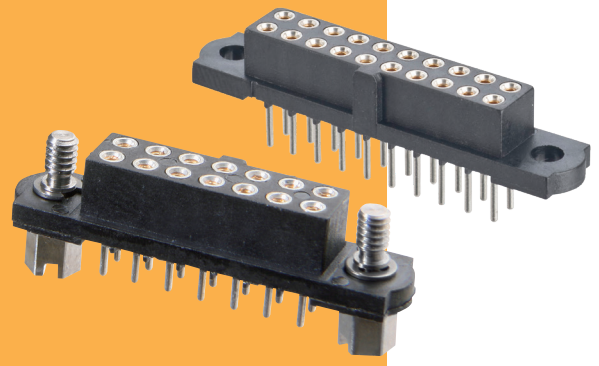

DATAMATE J-TEK

### WITHOUT JACKSCREWS

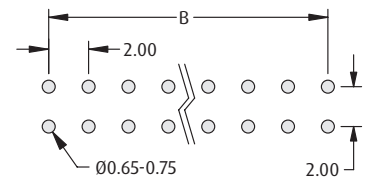
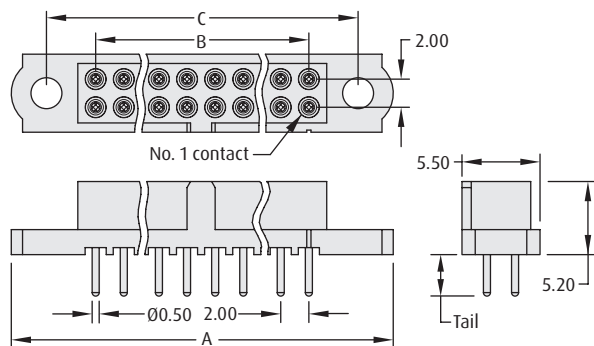

Recommended PC Board Pattern

#### CALCULATION

<b>A</b>	B + 12
<b>B</b>	Total no. of contacts - 2
<b>C</b>	B + 7

### WITH JACKSCREWS

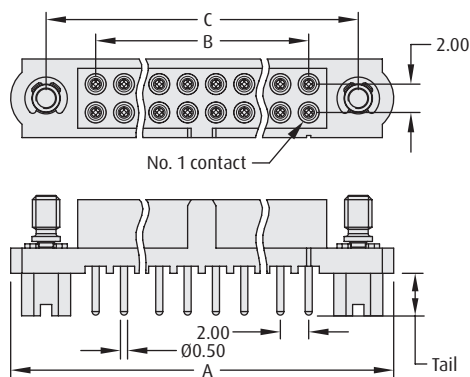

#### Hex Slotted Jackscrew

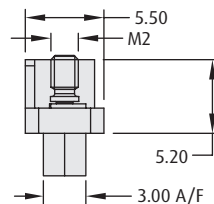

#### Hex Socket Jackscrew

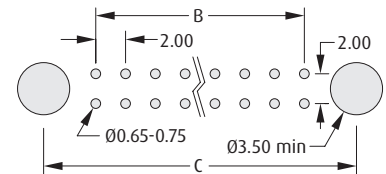
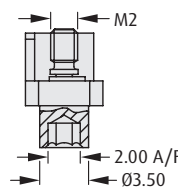

Recommended PC Board Pattern

### HOW TO ORDER

**M80 - 4 X X XX XX**

#### SERIES CODE

<b>0</b>	With Hex Slotted Jackscrews
<b>1</b>	Without Jackscrews
<b>2</b>	With Hex Socket Jackscrews

<b>0</b>	3mm Tails
<b>1</b>	4.5mm Tails

#### FINISH

<b>05</b>	Gold
<b>42</b>	Gold + Tin

#### TOTAL NO. OF CONTACTS

**04, 06, 08, 10, 12, 14, 20, 26, 34, 42, 50**

All dimensions in mm.