

RCI484BB0**Weidmüller Interface GmbH & Co. KG**

Klingenbergstraße 26

D-32758 Detmold

Germany

www.weidmueller.com

Product image

Similar to illustration

Individual relays within the RIDERSERIES RCI

- 2 CO contacts
- DC coils
- With integrated status LED, free-wheeling diode and test button

General ordering data

| | |
|---------------------|--|
| Version | RIDERSERIES RCI, Relay, Number of contacts: 2, CO contact AgNi, Rated control voltage: 110 V DC, Continuous current: 8 A, Plug-in connection, Test button available: Yes |
| Order No. | 8870340000 |
| Type | RCI484BB0 |
| GTIN (EAN) | 4032248613724 |
| Qty. | 10 pc(s). |
| Delivery status | This article will no longer be available in the future. |
| Available until | 2024-10-31 |
| Alternative product | 7760056342 |

Creation date March 12, 2024 12:12:58 PM CET

RCI484BB0

Weidmüller Interface GmbH & Co. KG

Klingenbergstraße 26

D-32758 Detmold

Germany

www.weidmueller.com

Technical data

Dimensions and weights

| | | | |
|------------|---------|-----------------|------------|
| Depth | 26.7 mm | Depth (inches) | 1.051 inch |
| Height | 29 mm | Height (inches) | 1.142 inch |
| Width | 13 mm | Width (inches) | 0.512 inch |
| Net weight | 17 g | | |

Temperatures

| | | | |
|---------------------|--|-----------------------|----------------|
| Storage temperature | -40 °C...85 °C | Operating temperature | -40 °C...70 °C |
| Humidity | 40 °C / 93 % rel. humidity, no condensation | | |

Rated data UL

| | |
|-------------------------|---------|
| Certificate No. (cURus) | E522350 |
|-------------------------|---------|

Control side

| | | | |
|-----------------------|---------------------|------------------|----------------|
| Rated control voltage | 110 V DC | Rated current DC | 4.6 mA |
| Power rating | 507 mW | Coil resistance | 28800 Ω ± 12 % |
| Coil tolerance | 12 % | Status indicator | Green LED |
| Protective circuit | Free-wheeling diode | | |

Load side

| | | | |
|---|---|---|--|
| Rated switching voltage | 240 V AC | Continuous current | 8 A |
| Max. switching frequency at rated load | 0.1 Hz | Max. switching voltage, AC | 250 V |
| Inrush current | 15 A / 4 s | AC switching capacity (resistive), max. | 2000 VA |
| DC switching capacity (resistive), max. | 192 W @ 24 V | Switch-on delay | ≤ 10 ms |
| Switch-off delay | ≤ 6 ms | Contact type | 2 CO contact (AgNi) |
| Mechanical service life | AC coil 5 x 10 ⁶ switching cycles, DC coil 10 x 10 ⁶ switching cycles | Min. switching power | 1 mA @ 24 V, 10 mA @ 12 V, 100 mA @ 5 V |

General data

| | | | |
|--------------------------------------|-----|------------------------|---|
| Test button available | Yes | Version of test button | lockable, just when removing the detend lock, Momentary test button |
| Mechanical switch position indicator | Yes | Colour | Transparent |
| UL 94 flammability rating | V-2 | | |

Insulation coordination

| | | | |
|--|--------------------------------|---|-----------------------------|
| Rated voltage | 250 V | Pollution severity | 2 |
| Surge voltage category | III | Insulating material group | IIIa |
| Clearance and creepage distances for control side - load side | ≥ 8 mm | Dielectric strength for control side - load side | 5 kV _{eff} / 1 min |
| Dielectric strength of neighbouring contacts | 2.5 kV _{eff} / 1 Min. | Dielectric strength of open contact | 1 kV _{eff} / 1 min |
| Impulse withstand voltage | 5 kV (1.2/50 μs) | | |

Further details of approvals / standards

| | | | |
|-------------------------|----------------|-----------------------|----------|
| Certificate No. (CSA) | 249409-2426937 | Certificate No. (VDE) | 40018043 |
| Certificate No. (cURus) | E522350 | | |

Creation date March 12, 2024 12:12:58 PM CET

Catalogue status 09.03.2024 / We reserve the right to make technical changes.

2

RCI484BB0

Weidmüller Interface GmbH & Co. KG

Klingenbergstraße 26

D-32758 Detmold

Germany

www.weidmueller.com

Technical data

Connection data

| | | | |
|------------------------|--------------------|-----------------|------|
| Wire connection method | Plug-in connection | Pitch in mm (P) | 5 mm |
|------------------------|--------------------|-----------------|------|

Classifications

| | | | |
|-------------|-------------|-------------|-------------|
| ETIM 6.0 | EC001437 | ETIM 7.0 | EC001437 |
| ETIM 8.0 | EC001437 | ETIM 9.0 | EC001437 |
| ECLASS 9.0 | 27-37-16-01 | ECLASS 9.1 | 27-37-16-01 |
| ECLASS 10.0 | 27-37-16-01 | ECLASS 11.0 | 27-37-16-01 |
| ECLASS 12.0 | 27-37-16-01 | ECLASS 13.0 | 27-37-16-01 |

Environmental Product Compliance

| | |
|------------|----------------|
| REACH SVHC | Lead 7439-92-1 |
|------------|----------------|

Approvals

Approvals



| | |
|-------------------------|------------|
| ROHS | Conform |
| UL File Number Search | UL Website |
| Certificate No. (cURus) | E522350 |

Downloads

| | |
|---|--|
| Approval/Certificate/Document of Conformity | EU Konformitätserklärung / EU Declaration of Conformity |
| Engineering Data | CAD data – STEP |
| Product Change Notification | 20220511 Product consolidation RIDERSERIES RCI relays 20220511 Produktkonsolidierung RIDERSERIES RCI Relais |
| Catalogues | Catalogues in PDF-format |
| Brochures | |

RCI484BB0

Weidmüller Interface GmbH & Co. KG
 Klingenbergstraße 26
 D-32758 Detmold
 Germany

www.weidmueller.com

Drawings

Wiring diagram

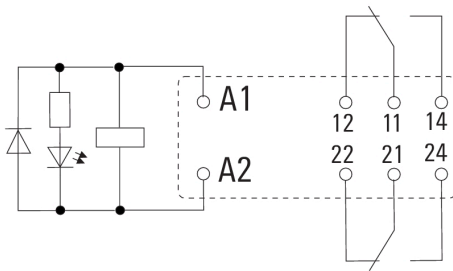

View of Pins from below

Graph

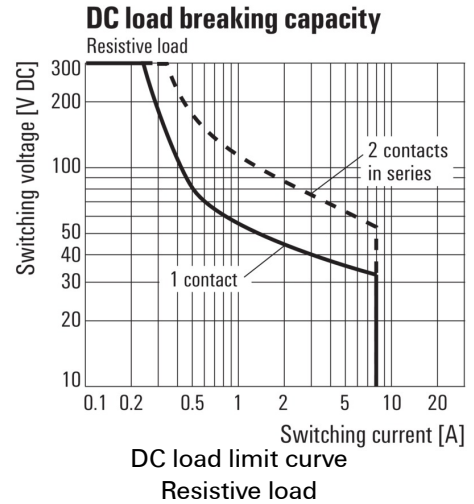

Graph

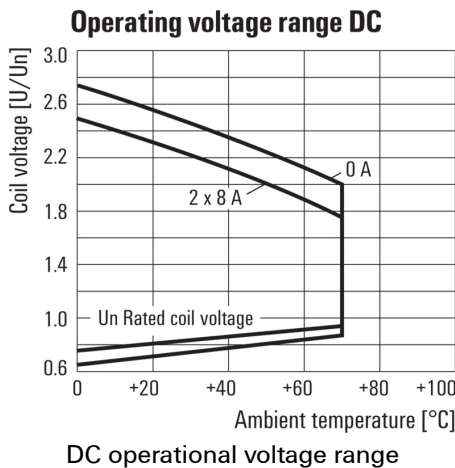

Graph

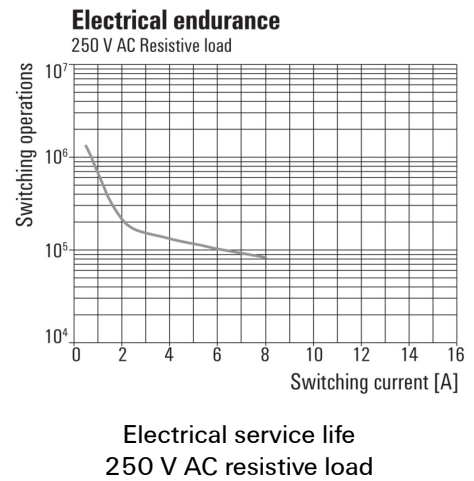

Dimensional drawing

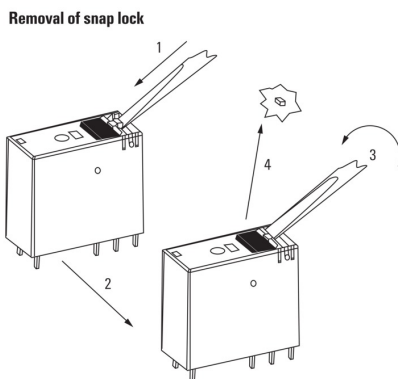

Detailed drawing
 Removal of the test button detent lock

Derating curve

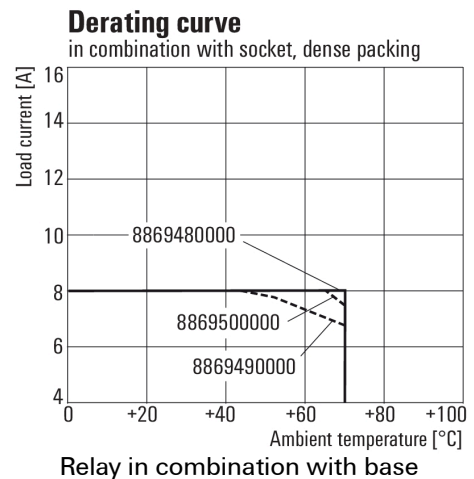

RCI484BB0

Weidmüller Interface GmbH & Co. KG
 Klingenbergstraße 26
 D-32758 Detmold
 Germany

www.weidmueller.com

Accessories

Cross-connection for socket with PUSH IN connection

Cross-connection for the sockets in the RIDERSERIES RCI.



General ordering data

| | | |
|------------|----------------------------|----------------------------------|
| Type | SRC-I QV P | Version |
| Order No. | 8870840000 | RIDERSERIES RCI, Cross-connector |
| GTIN (EAN) | 4032248631681 | |
| Qty. | 10 pc(s). | |

Protective varistor



Pluggable protective modules for the RIDERSERIES RCI / RCM relay sockets, with optional protective functions.

- With protective varistor
- For UC supply voltage

General ordering data

| | | |
|------------|----------------------------|--|
| Type | RIM-I 4 110VUC VAR | Version |
| Order No. | 8869730000 | RIDERSERIES, Protective varistor, Rated control voltage: 110 V UC, |
| GTIN (EAN) | 4032248606351 | Plug-in connection |
| Qty. | 10 pc(s). | |

RCI484BB0

Weidmüller Interface GmbH & Co. KG
 Klingenbergstraße 26
 D-32758 Detmold
 Germany

www.weidmueller.com

Accessories

Cross-connection for socket with screw connection

Cross-connection for the sockets in the D-SERIES DRI.



General ordering data

| | | |
|------------|----------------------------|----------------------------------|
| Type | SRC-I QV S | Version |
| Order No. | 1132070000 | RIDERSERIES RCI, Cross-connector |
| GTIN (EAN) | 4032248912087 | |
| Qty. | 10 pc(s). | |

ESG 6/17



Guaranteed long service life: ESG

The multi-colour and multi-format labels have a strong adhesive layer to ensure the best possible adhesion to the underlying surface. Double laminated polyester makes the basic material very thin and yet extremely tear-resistant.

Your benefits with MultiMark

- "Different materials for various requirements"
- Can be used with equipment from many manufacturers
- Device markers with a familiar design

General ordering data

| | | |
|------------|----------------------------|---------------------------------------|
| Type | ESG 6/17 MM WS | Version |
| Order No. | 2005100000 | ESG, Device markers, 6 x 17 mm, white |
| GTIN (EAN) | 4050118390728 | |
| Qty. | 3,000 pc(s). | |

RCI484BB0

Weidmüller Interface GmbH & Co. KG

Klingenbergstraße 26

D-32758 Detmold

Germany

www.weidmueller.com

Accessories

Sockets



Relay sockets for the RIDERSERIES RCI relays

- 1 and 2 CO contacts
- Screw and PUSH IN connection
- Standard and low heights

General ordering data

| | | |
|------------|----------------------------|---|
| Type | SRC-I 2CO N | Version |
| Order No. | 8869480000 | RIDERSERIES RCI, Relay socket, Number of contacts: 2, CO contact, |
| GTIN (EAN) | 4032248614431 | Continuous current: 8 A, Screw connection |
| Qty. | 10 pc(s). | |
| Type | SRC-I 2CO P | Version |
| Order No. | 8869500000 | RIDERSERIES RCI, Relay socket, Number of contacts: 2, CO contact, |
| GTIN (EAN) | 4032248614455 | Continuous current: 8 A, PUSH IN |
| Qty. | 10 pc(s). | |
| Type | SRC-I 2CO | Version |
| Order No. | 8869490000 | RIDERSERIES RCI, Relay socket, Number of contacts: 2, CO contact, |
| GTIN (EAN) | 4032248614448 | Continuous current: 8 A, Screw connection |
| Qty. | 10 pc(s). | |

Retaining clips



Retaining clip for RIDERSERIES RCI relays

- Metal and plastic retaining clip

General ordering data

| | | |
|------------|----------------------------|---------------------------------|
| Type | SRC-I CLIP HP | Version |
| Order No. | 8869510000 | RIDERSERIES RCI, Retaining clip |
| GTIN (EAN) | 4032248614462 | |
| Qty. | 10 pc(s). | |
| Type | SRC-I CLIP HM RCI | Version |
| Order No. | 1132090000 | RIDERSERIES RCI, Retaining clip |
| GTIN (EAN) | 4032248912209 | |
| Qty. | 20 pc(s). | |

RCI484BB0

Weidmüller Interface GmbH & Co. KG
 Klingenbergstraße 26
 D-32758 Detmold
 Germany

www.weidmueller.com

Accessories

Blank



ESG is the tried-and-tested marker in MultiCard format for use on many well-known electrical devices. The result is high-quality device marking with a high-contrast appearance.

Various types are available for devices from manufacturers like Siemens, ABB, Beckhoff etc. Advantages at a glance:

- Tags for universal usage, self-adhesive or clip-on tags, depending on type
- For aligned equipment, e.g. circuit breakers, we supply ESG markers for clipping onto tag rails
- Individual laser-quality printing according to specifications

For custom printing: Please send us a file of our labeling software M-Print PRO or M-Print PRO Online (without installation) for your labeling specifications.

General ordering data

| | | |
|------------|----------------------------|---|
| Type | ESG 6/15 SRC-I MC NE WS | Version |
| Order No. | 2558350000 | ESG, Device markers x 15 mm, PA 66, Colour: white |
| GTIN (EAN) | 4050118569063 | |
| Qty. | 200 pc(s). | |

ESG 6/15



Guaranteed long service life: ESG

The multi-colour and multi-format labels have a strong adhesive layer to ensure the best possible adhesion to the underlying surface. Double laminated polyester makes the basic material very thin and yet extremely tear-resistant.

Your benefits with MultiMark

- "Different materials for various requirements"
- Can be used with equipment from many manufacturers
- Device markers with a familiar design

General ordering data

| | | |
|------------|----------------------------|---------------------------------------|
| Type | ESG 6/15 MM WS | Version |
| Order No. | 2619940000 | ESG, Device markers, 6 x 15 mm, white |
| GTIN (EAN) | 4050118626148 | |
| Qty. | 3,000 pc(s). | |

RCI484BB0

Weidmüller Interface GmbH & Co. KG
 Klingenbergstraße 26
 D-32758 Detmold
 Germany

www.weidmueller.com

Accessories

LED / Free-wheel diode



Pluggable protective modules for the RIDERSERIES RCI / RCM relay sockets, with optional protective functions.

- Optional with green or red LED
- With free-wheeling diode
- For DC supply voltage

General ordering data

| Type | RIM-I 2 110/230VDC GN | Version |
|------------|----------------------------|---|
| Order No. | 8869700000 | RIDERSERIES, LED module with freewheel diode, Rated control |
| GTIN (EAN) | 4032248614639 | voltage: 110...230 V DC, Plug-in connection |
| Qty. | 10 pc(s). | |

| Type | RIM-I 2 110/230VDC | Version |
|------------|----------------------------|---|
| Order No. | 8869690000 | RIDERSERIES, LED module with freewheel diode, Rated control |
| GTIN (EAN) | 4032248614622 | voltage: 110...230 V DC, Plug-in connection |
| Qty. | 10 pc(s). | |

Protection module



Pluggable protective modules for the RIDERSERIES RCI / RCM relay sockets, with optional protective functions.

- Optional with free-wheeling diode, protective varistor, load resistor or RC filter

General ordering data

| Type | RIM-I 1 6/230V | Version |
|------------|----------------------------|--|
| Order No. | 8869580000 | RIDERSERIES, Free-wheeling diode, Rated control voltage: 6...230 V |
| GTIN (EAN) | 4032248614523 | DC, Plug-in connection |
| Qty. | 10 pc(s). | |

| Type | RIM-I 1 R 110/230V | Version |
|------------|----------------------------|---|
| Order No. | 8870830000 | RIDERSERIES, Load, Rated control voltage: 110...230 V UC, Plug-in |
| GTIN (EAN) | 4032248631674 | connection |
| Qty. | 10 pc(s). | |

RCI484BB0

Weidmüller Interface GmbH & Co. KG
 Klingenbergstraße 26
 D-32758 Detmold
 Germany

www.weidmueller.com

Accessories

LED



Pluggable protective modules for the RIDERSERIES RCI / RCM relay sockets, with optional protective functions.

- Optional with green or red LED
- For UC supply voltage

General ordering data

| | | |
|------------|----------------------------|---|
| Type | RIM-I 3 110/230VUC GN | Version |
| Order No. | 8869660000 | RIDERSERIES, LED module, Rated control voltage: 110...230 V UC, |
| GTIN (EAN) | 4032248614721 | Plug-in connection |
| Qty. | 10 pc(s). | |
| Type | RIM-I 3 110/230VUC | Version |
| Order No. | 8869650000 | RIDERSERIES, LED module, Rated control voltage: 110...230 V UC, |
| GTIN (EAN) | 4032248614592 | Plug-in connection |
| Qty. | 10 pc(s). | |

RCI484BB0

Weidmüller Interface GmbH & Co. KG
 Klingenbergstraße 26
 D-32758 Detmold
 Germany

www.weidmueller.com

Drawings

Dimensional drawing

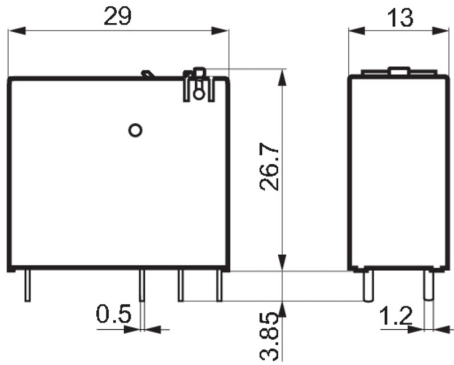

Miscellaneous

| | RCI | | | | |
|--|-----|--|--|---------------------|------------------------|
| Type RIDER Control Industrial | | | | | |
| Type of construction 3 16 A pinning 5 mm 4 8 A, pinning 5mm | | | | | |
| Type of contact 1 1 CO without push button 2 2 CO without push button 7 1 CO with push button 8 2 CO with push button | | | | | |
| Contact material 4 AgNi 90/10 | | | | | |
| | | | | Coil voltage | |
| | | | | 012 | 12 V DC |
| | | | | 024 | 24 V DC |
| | | | | 048 | 48 V DC |
| | | | | 110 | 110 V DC |
| | | | | AB2 | 12 V DC + LED + diode |
| | | | | AC4 | 24 V DC + LED + diode |
| | | | | AE8 | 48 V DC + LED + diode |
| | | | | BB0 | 110 V DC + LED + diode |
| | | | | 524 | 24 V AC |
| | | | | 615 | 115 V AC |
| | | | | 730 | 230 V AC |
| | | | | R24 | 24 V AC + LED |
| | | | | S15 | 115 V AC + LED |
| | | | | T30 | 230 V AC + LED |

Type codes